



RCF系列离心式屋顶风机

RCF SERIES CENTRIFUGAL ROOF FAN



◎风机型号说明 Designation of products



●本系列风机类型为离心式上排风屋顶风机，采用铝制后倾离心式叶轮，风机进口文丘里管截面呈圆弧形。叶轮经过动平衡，达到国际标准ISO 1940 G2.5水平。

●风机外壳、叶轮采用铝合金材料。

●电机与风机负载匹配，电机防护等级为IP44，绝缘等级为B级，电机轴承为滚珠轴承。电机和驱动机构置于气流之外，以免产生灰尘或油脂堆积。

●风机罩与外风筒：分别用厚铝板旋压而成，有卷边可承受外部强度，能承受较大的风载荷。其结构形式及安装要求能防止大雨或融雪的漏水。

●驱动机构支撑板：使用防腐的镀锌钢板制作，结构强度能保证驱动部件正常运转而不发生较大振动。

●泛水罩：泛水罩与进风口一体化拉伸成型设计防止渗水，泛水罩四侧面设计有安装孔，用于与屋顶泛水结构固定。

●防鸟网：优质冷拉铁线制作，坚固防锈，并保证在风机运行或停止运行时保护风机出风口不受鸟类或小物件的影响。

●性能参数按照AMCA第210和310标准进行检测。风机参数是以风机整机运转进行实验检测所得数据。

●本系列风机有250、280、315、355、400、450、500、560、630、710、800、900、1000共13个机号。

◎用途及使用条件

●使用场所：适合安装在工矿厂房、民用建筑、大型商场等场所的屋顶作为抽排风用途。

●输送的介质要求：输送的介质应为空气或其它无腐蚀性、不易燃易爆、不含粘性物质的气体，气体内所含尘土及硬物颗粒含量不大于150mg/m³。

●输送的介质温度：标准风机输送的介质温度不大于80℃。

●The series of fan type is upper exhaust type centrifugal roof fan which adopts backward centrifugal aluminum impeller. The fan inlet venturi tube has a circular arc shape to ensure smooth flow with the fan inlet. The impeller is statically and dynamically balanced to meet the international standard ISO 1940 G2.5.

●The fan casing and impeller are made of aluminum alloy.

●The motor is matched to the fan load, motor protection class is IP44, insulation class is B, ball bearings. The motor and drive mechanism are placed outside the airflow to prevent dust or grease build-up.

●Fan cover and outer housing: Made of thick aluminum plate, which can withstand external strength and large wind load. Its structural form and installation requirements prevent leakage of heavy rain or snow.

●Drive mechanism support plate: Made of anti-corrosion galvanized steel plate, the structural strength can ensure the normal operation of the drive components without large vibration.

●Flashing: The flashing and the air inlet are integrated and stretched to prevent water seepage. The four sides of flashing are designed with mounting holes for fixing to the roof flashing structure.

●Anti-bird grill: Made of high-quality cold-drawn iron wire, sturdy and anti-rust, and ensure that the fan air outlet is protected from birds or small objects when the fan is running or stopped.

●Fan parameters are tested in accordance with Air Movement and Control Association Standards 210 and 310. The fan parameters are experimentally tested by the operation of the whole fan.

●Models:250, 280, 315, 355, 400, 450, 500,560,630,710,800, 900 and 1000 in all 13 models.

◎Application and condition

●Application: It is suitable for installation on the roof of industrial and mining plants, civil buildings, shopping malls and other places for the purpose of extraction and exhaust.

●Transmission medium requirements: The transmission medium should be air or other gas without corrosiveness, inflammability and explosibility, and not contain stickup. Dust and other particles included in the air can not be beyond 150mg/m³. If used for transmission particles, the life of impeller will be shortened.

●Transmission medium temperature: below 80℃ with standard structure.



RCF系列离心式屋顶风机

RCF SERIES CENTRIFUGAL ROOF FAN

RCF-500性能曲线 PERFORMANCE CURVE

Static Pressure
(Pa)

Air Density: 1.2 kg/m³

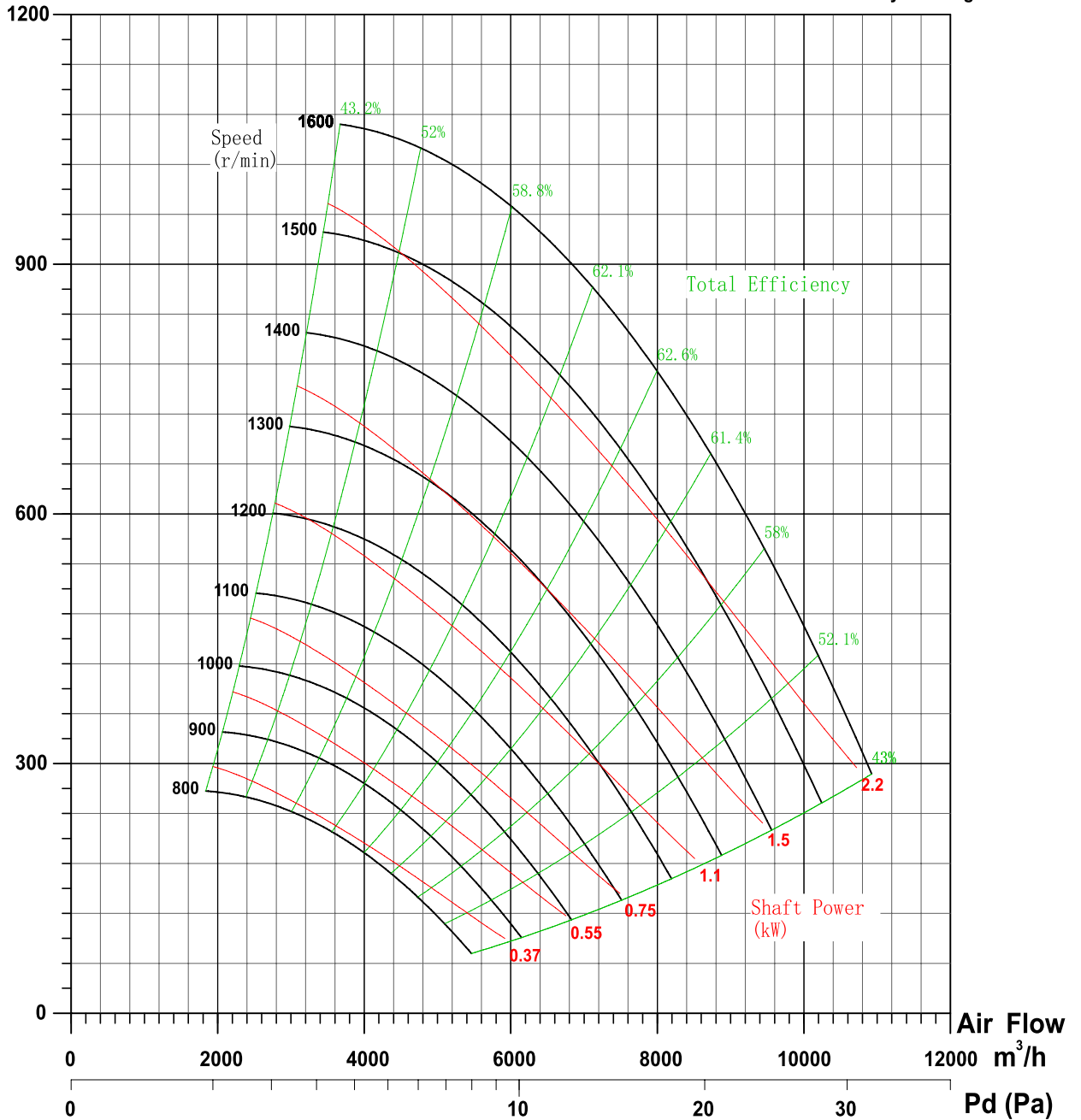



RCF系列离心式屋顶风机

RCF SERIES CENTRIFUGAL ROOF FAN

RCF-450C性能参数表 Performance Chart

转速 Speed (r/min)	流量 Q (m ³ /h)	全压 Pt (Pa)	静压 Pst (Pa)	轴功率 Shaft Power (kW)	声压级 Lp dB(A)	电机功率 Motor Power	风机重量 Weight (kg)
1650	4498	824	814	2.14	77	3kW-4	88
	5664	750	733	2.30			
	6403	672	650	2.38			
	7153	566	539	2.38			
	7616	472	441	2.33			
	8138	356	321	2.22			
	8509	222	183	2.07			
1450	3953	637	628	1.45	73	2.2kW-4	84
	4978	579	566	1.56			
	5627	519	502	1.61			
	6286	437	416	1.61			
	6693	365	341	1.58			
	7152	275	248	1.51			
	7478	171	141	1.41			
1300	3544	512	505	1.05	70	1.5kW-4	77
	4463	465	455	1.13			
	5045	417	403	1.16			
	5636	351	334	1.16			
	6001	293	274	1.14			
	6412	221	199	1.09			
	6704	138	114	1.01			
1150	3135	400	395	0.72	66	1.1kW-4	73
	3948	364	356	0.78			
	4463	326	316	0.81			
	4986	275	262	0.81			
	5308	229	214	0.79			
	5672	173	156	0.75			
	5931	108	89	0.70			
1050	2862	334	329	0.55	64	0.75kW-4	67
	3605	304	297	0.59			
	4075	272	263	0.61			
	4552	229	218	0.61			
	4847	191	179	0.60			
	5179	144	130	0.57			
	5415	90	74	0.53			
910	2481	251	247	0.36	61	0.55kW-4	65
	3124	228	223	0.39			
	3531	204	198	0.40			
	3945	172	164	0.40			
	4201	144	134	0.39			
	4488	108	98	0.37			
	4693	67	56	0.35			

注:表中的重量数据不包含配用电机的重量。

Description: Table not include the weight of motor.



RCF系列离心式屋顶风机

RCF SERIES CENTRIFUGAL ROOF FAN

外形尺寸 Dimension

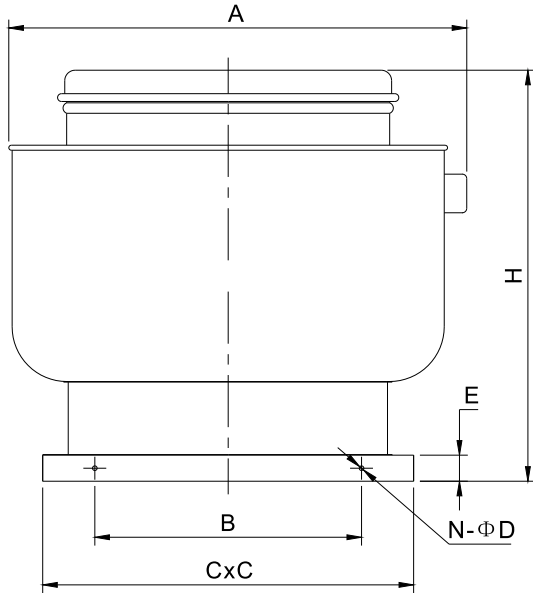

型号 Model	A	B	C×C	N-ΦD	E	H
250	784	430	630×630	8-Φ9	50	660
280	784	430	630×630	8-Φ9	50	680
315	784	430	630×630	8-Φ9	50	700
355	784	430	630×630	8-Φ9	50	715
400	784	430	630×630	8-Φ9	50	740
450	904	560	760×760	8-Φ9	50	880
500	904	560	760×760	8-Φ9	50	920
560	1120	700	900×900	8-Φ9	50	990
630	1120	700	900×900	8-Φ9	50	1040
710	1282	920	1120×1120	12-Φ12	50	1180
800	1462	1100	1300×1300	12-Φ12	50	1220
900	1462	1100	1300×1300	12-Φ12	50	1320
1000	1462	1100	1300×1300	12-Φ12	50	1390

屋顶泛水尺寸 Roof flashing dimension

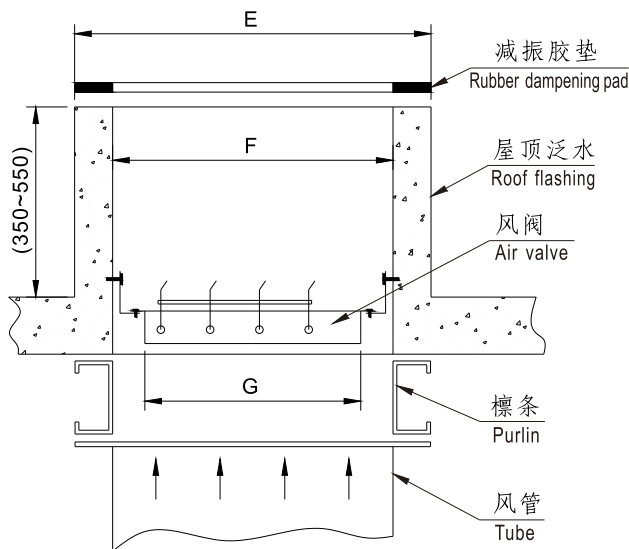

型号 Model	泛水外沿尺寸 Flashing size	泛水开洞尺寸 Hole size		风阀尺寸 Air valve size
		(钢制泛水) Steel structure	(混凝土泛水) Concrete structure	
	E	F	F	G
250	620	520	460	350
280	620	520	460	350
315	620	520	460	350
355	620	520	460	350
400	620	520	460	350
450	750	650	590	500
500	750	650	590	500
560	990	890	830	740
630	990	890	830	740
710	1110	1010	950	860
800	1290	1190	1130	1040
900	1290	1190	1130	1040
1000	1290	1190	1130	1040